

# ANNAPOLIS MARY GARDEN

*St. Mary's Parish Annapolis, Maryland*

## *Visitors' Guide*

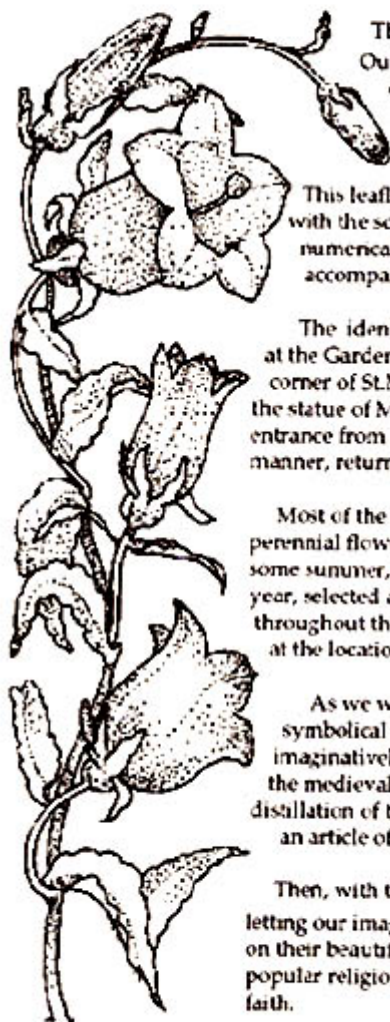

The religious names of the symbolical Flowers of Our Lady in the Annapolis Mary Garden are displayed, together with their more familiar common names, on hand-crafted wooden markers at each flower group.

This leaflet provides a full list of these names, together with the scientific botanical name for each species, and a numerical key indicating the location for each in the accompanying plan of the Garden.

The identifying plant numbers start in the left border bed at the Garden entrance from the parking lot by the southeast corner of St. Mary's Church, and then continue up this bed to the statue of Mary of Nazareth at the rear border by the entrance from the church. They then proceed in clockwise manner, returning back to the starting point.

Most of the flowers indicated on the plan are biennial or perennial flowers of limited bloom duration - some spring, some summer, and some fall. For Garden color through the year, selected annual flowers, as indicated (\*), have been planted throughout the Garden, as well as in the larger colonies of each at the locations indicated by their identifying numbers.

As we walk through the Garden, we can view the symbolical forms and colors of the flowers and foliage imaginatively as they might have been seen by the faithful of the medieval countryside, who perceived each in love as the distillation of the quality of a mystery or virtue or event; or of an article of reverence.

Then, with this sense, we can take the list home with us, letting our imaginations range over the flowers, and reflecting on their beautiful, pure contribution to the richness of the popular religious traditions mirroring and quickening our faith.

*Our Lady's Smock*

# ANNAPOLIS MARY GARDEN

1991

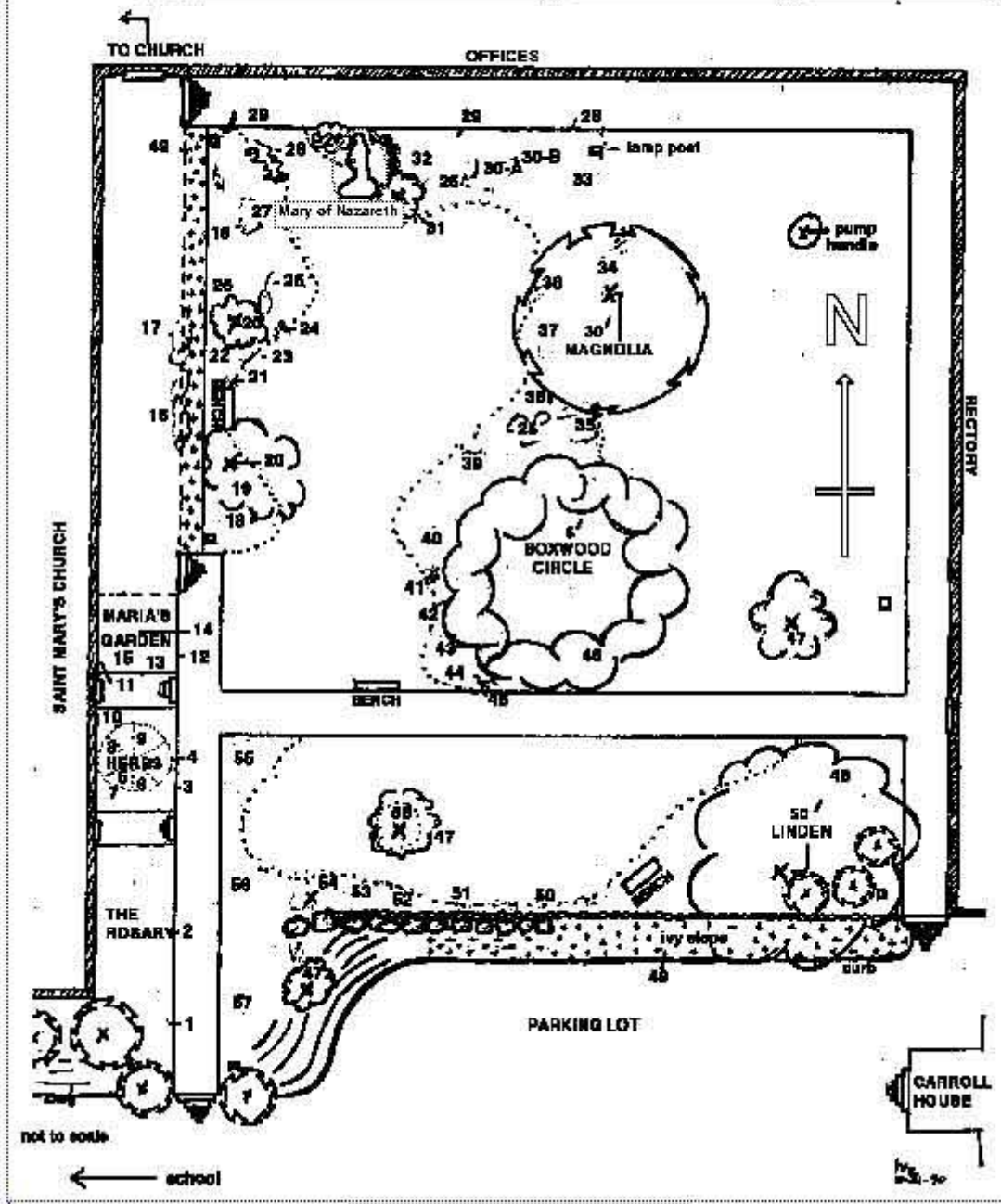

COMMON NAME

RELIGIOUS NAME

BOTANIAL NAME

- |                    |                  |                               |
|--------------------|------------------|-------------------------------|
| 1. Sage            | Mary's Shawl     | <i>Salvia officinalis</i>     |
| 2. Roses           | The Rosary       | <i>Rosa</i> sp.               |
| 3. Creeping Thyme  | Mary's Bedstraw  | <i>Thymus serpyllum</i>       |
| 4. Lavender Cotton | St. John's Plant | <i>Santolina chama.</i>       |
| 5. Everlasting     | Lady Neverfade   | <i>Antennaria dioica</i>      |
| 6. Harebell        | Lady's Thimble   | <i>Campanula rotundifolia</i> |
| 7. Red Yarrow      | Christ's Back    | <i>Achillea millefolium</i>   |
| 8. Wild Cranesbill | Madonna's Pins   | <i>Geranium maculatum</i>     |
| 9. Strawberry      | Faithfulness     | <i>Fragaria vesca</i>         |

10. Roman Wormwood	Lady's Needle	Artemisia pontica
11. Thistle (?)	Mary's Nettle	(?)
12. Star of Bethlehem	Bethlehem Star	Ornithogalum umbel.
13. Geranium	Madonna's Pins	Pelargonium
14. Lady Apple	Lady Apple	Pyrus Malus var.
15. Russian Sage	Perovskia	Perovskia atripl.
16. Clematis	Virgin's Bower	Clematis vitalba
17. Honeysuckle	Lady Fingers	Loniera caprifolium
18. Hydranga	Ave Maria	Hydranga macro mar.
19. Goutweed	Bishop's Weed	Aegopodium podagraria
20. Crepe Myrtle	Her Virginity	Myrtus communis
21. Angel Wing Begonia	Heart of Jesus	Begonia argentic
22. Lily-of-the Valley	Stairway to Heaven	Convallaria majellus
23. Lady's Mantle	Lady's Mantle	Alchemilla speciosa
24. Madonna Lily	Madonna Lily	Lilium speciosum
25. Peony	Mary's Rose	Paeonia officinalis
26. Veronica	Mary's Faith	Veronica longifolia
27. Rose	Mary's Rose	Rosa sp.
28. English Lavender	Flight Into Egypt	Lavandula angustifolia
29. Maiden Grass	Maiden Grass	Miscanthus sp.
30A German Iris	Mary's Sword	Iris germanica
30B Valerian	Keys to Heaven	Valeriana offic.
31. Hawthorn	Mary's Berry	Craetaegus monogyna
32. Blue Phlox	Lady's Wedding	Phlox divaricata
33. Rhododendron	St. John's Mayflower	Rhododendron
34. White Plantain Lily	Assumption Lily	Hosta plantaginea
35. Turkestan Rose	Mary's Rose	Rosa rugosa
36. Spiderwort	Lady's Tears	Tradescantia virg.
37. Loostrife	Cross-Wort	Lysimachia quadrif.
38. Foxglove	Virgin's Glove	Digitalis purpurea
39. Day Lily	Fleur de Lys	Hemerocallis lilio.
40. Blue Star	Tabernacle	Amsonia tabern.
41. Wall Pepper	Lady's Hair	Sedum acre
42. Dahlia	Churchyard Flower	Dahlia pinnata
43. Japanese Iris	Trinity	Iris japonica
44. Pansy	Lady's Delight	Viola tricolor
45. Hemp Tree	Chaste Tree	Vitex agnus-castus
46. Boxwood	Candlemas Greens	Buxus sempervirens
47. Dogwood	Tree of the Cross	Cornus florida
48. Azalea	St. Joseph, Protector	Azalea sp.
49. English Ivy	Where God Walked	Hedera helix
50. Jasmine	Lady of Snows	Jasminum azoricum
51. Guelder Rose	Lady's Pincushion	Viburnum opulus
52. Hollyhock	St. Joseph's Staff	Alcea rosea
53. Black-Eyed Susan	Golden Jerusalem	Rudbeckia hirta
54. Stewartia	Purity	Camellia pseuco cam.
55. Petunia	Petunia	Petunia hybrida
56. Lantana	Sorrowful Face of M.	Lantana montevis.
57. Yucca	Lord's Candle	Yucca aloifolia
58. Chrysanthemum	Three Kings	Chrysanthemum ind.
--. Impatiens	Jesus Tears	Impatiens wallerana
--. Zinnea	The Virgin	Zinnea elegans

#### Considered For Future

Ajuga	St. Lawrence Gridiron	Ajuga reptans
Alyssum	Mary's Little Cross	Alyssum maritimum
Anemone	Rose of Sharon	Anemone coronaria
Bleeding Heart	Heart of Mary	Dicentra spectabilis

Buttercup	Our Lady's Splender	Ranunculus acris
Calendula	Mary's Gold	Calendula officinalis
Candytuft	Easter Flower	Iberis sempervirens
Canterbury Bells	Our Lay's Nightcap	Campanula medium
Columbine (spurs)	Our Lady's Shoes	Aquilegia vulgaris
Cornflower	Mary's Crown	Centaurea cyanis
Crocus	Penitent's Flower	Crocus vernus
Daffodil	Mary's Star	Narcissus psuedonarc.
Daisy	Jesus; Eye	Chrysanthemum leuc.
Delphinium	Mary's Tears	Delphinium ajacis
English Daisy	Mary Loves	Bellis perennis
Forget-me-not	Eyes of Mary	Myosotis scorpioides
Fuller's Teasel	Mary's Little Brushes	Dipsacus fllosum
Holly	Burning Bush	Ilex (genus)
Hyacinth	Easter Flower	Hyacinthus orientalis
Loosestrife	Christ's Blood	Lythrum salicaria
Maiden Pink	Mary's Pink	Dianthus plumarius
Marigold	Mary's Gold	Tagetes (genus)
Matricary	Mary's Flower	Matricaria inodora
Morning Glory	Our Lady's Mantle	Ipomoea purpurea
Mullein	Our Lady's Candle	Verbascum thapsus
Passion Flower	Passion Flower	Passiflora incarnata
Periwinkle	Virgin Flower	Vinca minor
Rose Campion	Mary's Rose	Mary's Rose
Snowdrop	Candlemas Bells	Galanthus nivalis
Spiderwort	Mary's Tears	Tredecantia virgin.
Squill	Church Steeples	Scilla bifolia
Thrift	Our Lady's Pincushn	Armeria maritima
Tulip	Mary's Prayer	Tulipa gesnaria
Violet	Mary's Humility	Viola odorata